



The MKA-23 is recommended for use with all Minn Kota® Fortrex®, Maxxum®, Edge, and Ultrex freshwater trolling motors. The RTA-19 is recommended for use with all Minn Kota® RT Fortrex®, RT Maxxum®, and RT Edge saltwater trolling motors.

Item / Assembly	Part #	Description	Qty.
2	2371970	PLATE-INNER MAX/AT QCK REL.	1
	2371971	PLATE-INNER MAX/AT QRB BLK.	1
4	2371972	PLATE-OUTER MAX/AT QCK REL.	1
	2371973	PLATE-OUTER MAX/AT QRB BLK.	1
6	2990907	HANDLE ASSY MAX/AT QRB.	1
A Includes 8-24	2994854	BAG ASSY MAX/AT FW/SW QRB	1
8	2372633	PIN-PADLOCK MAX/AT QCK REL.	1
10	2260800	CLIP-HAIR SPRING,SS,MAX BG	1
12	2373484	SCREW-1/4-20 X 7/8 PFH SS	1
14	2373482	SCREW-1/4-20 X 3" PFH SS	4
16	2261713	WASHER-1/4 FLAT 18-8 SS	4
18	2371712	WASHER-FLAT 9/32 X 5/8 X 1/16	6
20	2373486	SCREW-1/4-20 X 2 1/2 SHCS SS	6
22	2073410	SCREW-1/4-20 X 1.125 SHCS SS	6
24	2263103	NUT-1/4-20 NYLOCK SS	10
▲	2374918	INSTRUCTIONS MAX/AT QRB	1

✳ Not shown on Parts Diagram.

▲ This part is included in an assembly and cannot be ordered individually.

NOTICE: Images are a graphical representation and may vary from your motor. **Save the box!** A template for installation is printed on the inside of the box.

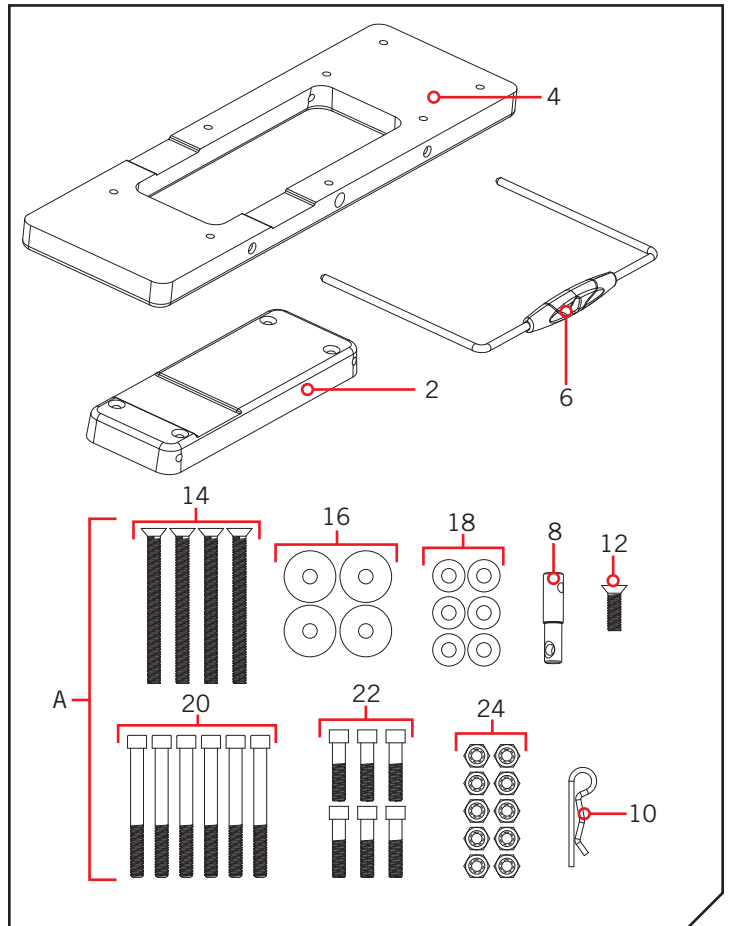

TOOLS AND RESOURCES REQUIRED >

- #2 Phillips Screw Driver
- Drill
- 9/32" Drill Bit
- 7/16" Box End/Open End Wrench
- Scissors
- Socket Wrench

MOUNTING CONSIDERATIONS >

It is recommended that the motor be mounted as close to the centerline of the boat as possible. The motor must not encounter any obstructions as it is lowered into the water or raised into the boat when stowed and deployed. Make sure the motor rest is positioned far enough beyond the edge of the boat. Make sure the area under the mounting location is flat, clear to drill holes and install nuts and washers.

NOTICE: Minn Kota motors can weigh up to 65lbs. It is recommended to have a second person help with the installation.

Complete Typical Installation

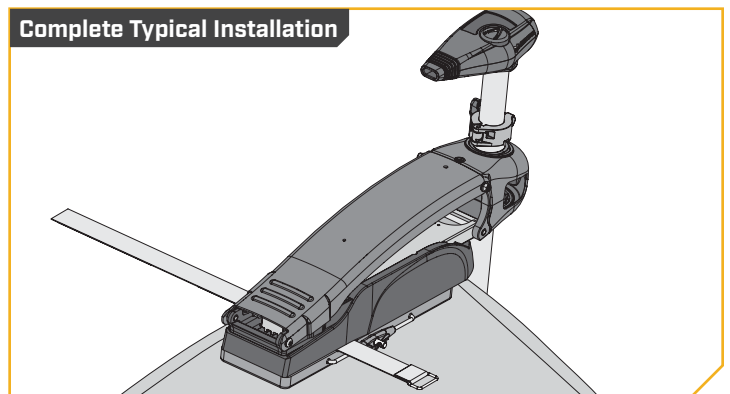

⚠ WARNING

For motors with Lift Assist (Fortrex, RT Fortrex, Ultrex), the Lift Cylinder should be disengaged until installation is complete to prevent injury. For instructions on how to disengage the Lift Cylinder, please see the Owner's Manual for your trolling motor at www.minnkotamotors.com.

The MKA-23 is designed to be compatible with the Ultrex™, Fortrex®, Edge and Maxxum® Minn Kota® motors. The RTA-19 is designed to be compatible with the RT Fortrex®, RT Edge and RT Maxxum® Minn Kota® motors. The base extrusion or motor rest of the trolling motors may vary. Please note the appearance of the applicable trolling motors and mounting brackets. For a complete list of motors compatible with the MKA-23/RTA-19, please refer to the website at minnkotamotors.com.

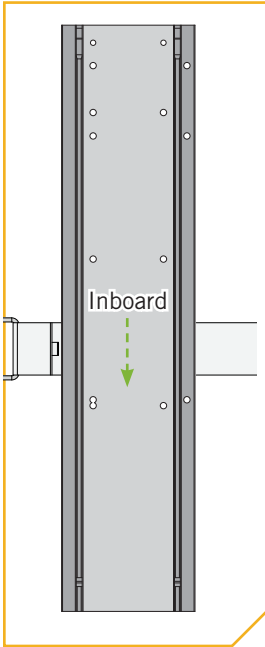

Ultrex

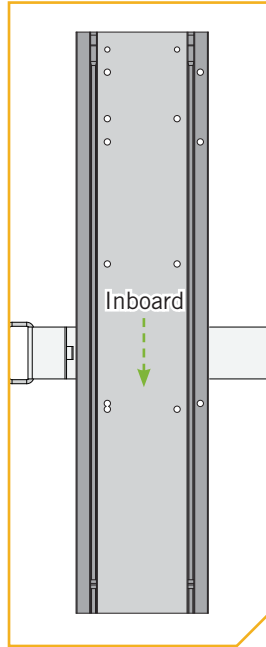

Fortrex &
RT Fortrex

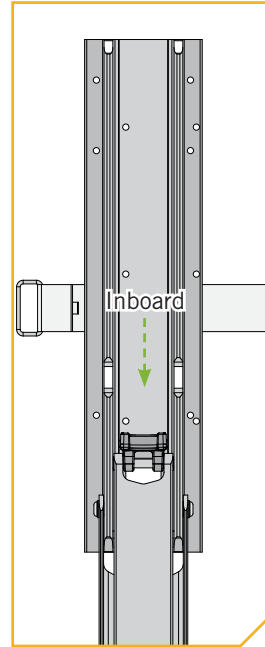

Edge &
RT Edge

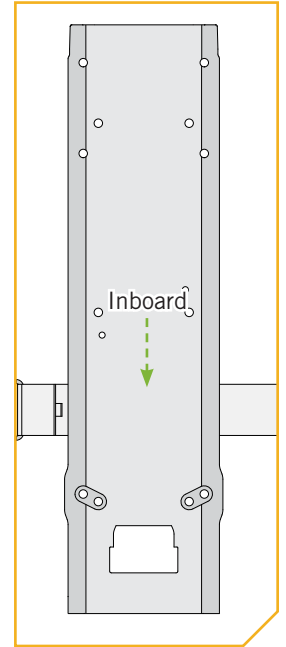

Maxxum &
RT Maxxum

INSTALLATION >

> Installing the Outer Plate to an Edge or RT Edge

- 1 a. Determine the mounting hole pattern you wish to use. The bolt pattern selected will depend on the deck space available on your boat.

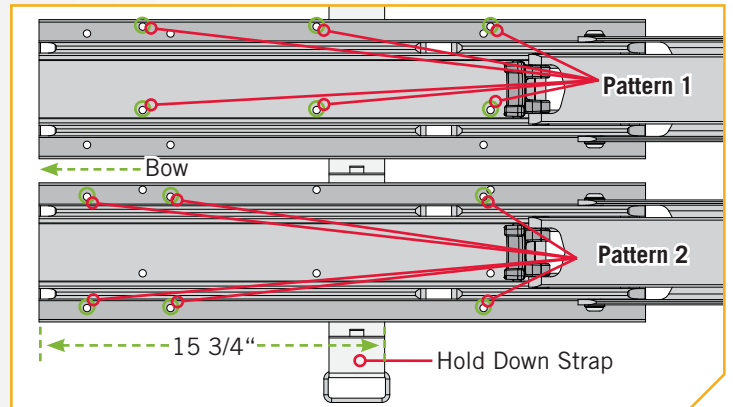

2

- b. Three of the mounting holes to be used are located under the Motor Rest. Depending on the desired mounting pattern, at least one side of the Motor Rest will need to be removed to access these holes.
- c. Using a #2 Screwdriver, temporarily remove the three Phillips Screws that fasten the Motor Rest to the Bowplate Extrusion. Remove the Motor Rest to expose the motor Mounting Holes.

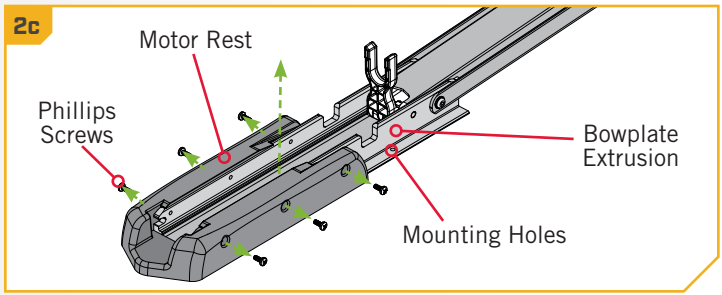

3

ITEM(S) NEEDED

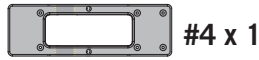

- d. Place the Stabilizer Strap (if included with your motor) into the Relief Cut on the Outer Plate (Item #4). Orientate the buckle to the desired side. The Relief Cut should face farthest inboard on the final installation.
- e. The placement of the buckle on the Stabilizer Strap is based on personal preference and can be placed either inboard or outboard. The hook and loop on the fastener should be face down for the Stabilizer Strap to function. Test the placement of the Stabilizer Strap to be sure it can hold the Mount as placed.
- f. Align the Base Extrusion with the Mounting Holes of the Outer Plate.

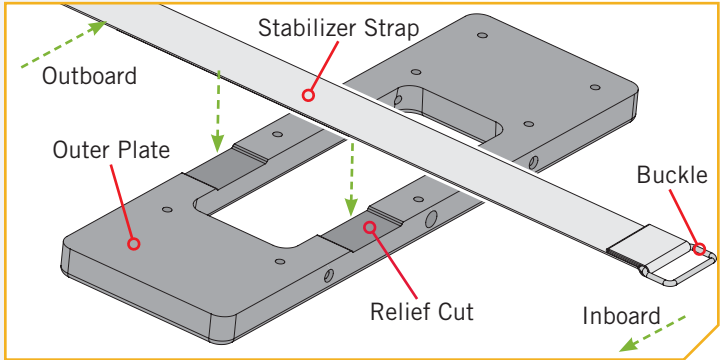

CAUTION

The Stabilizer Strap must be located in the Relief Cut or failure of the Quick Release Bracket may occur.

4

ITEM(S) NEEDED



- g. Using a Socket Wrench, fasten the Base Extrusion to the Outer Plate with six 1/4" x 1 1/8" Socket Head Screws (Item #22), six Flat Washers (Item #18) and six Nylock Nuts (Item #24). The Screws should pass through the Base Extrusion, then the Outer Plate, then the Flat Washers and secured with a Nylock Nut.
- h. Reinstall the Motor Rest that was removed using the Screws and a #2 Screwdriver.

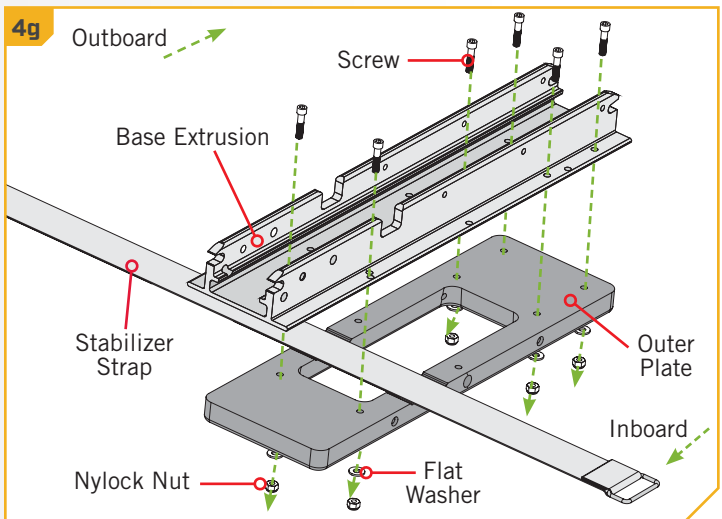

NOTICE: To prevent seizing of the stainless steel hardware, do not use high speed installation tools. Wetting the screws or applying an anti-seize may help prevent seizing.

› Installing the Outer Plate to a Maxxum or RT Maxxum

1

ITEM(S) NEEDED



#4 x 1



#20 x 6

○ #18 x 6

● #24 x 6

- Align the Maxxum/RT Maxxum Bow-mount with the mounting holes of the Outer Plate (Item #4).
- Place the Stabilizer Strap (if included with your motor) into the Relief Cut on the Outer Plate. Orientate the buckle to the desired side. The Relief Cut should face farthest inboard on the final installation.
- The placement of the buckle on the Stabilizer Strap is based on personal preference and can be placed either inboard or outboard. The hook and loop on the fastener should be face down for the Stabilizer Strap to function. Test the placement of the Stabilizer Strap to be sure it can hold the Mount as placed.

NOTICE: To prevent seizing of the stainless steel hardware, do not use high speed installation tools. Wetting the screws or applying an anti-seize may help prevent seizing.

- With a #2 Screwdriver, use six 1/4" x 2 1/2" Socket Head Screws (Item #20), six Flat Washers (Item #18) and six Nylock Nuts (Item #24) to fasten the Bow-mount to the Outer Plate. The Screws should pass through the Bow-mount, then the Outer Plate, then be secured with a Flat Washer and Nylock Nut.

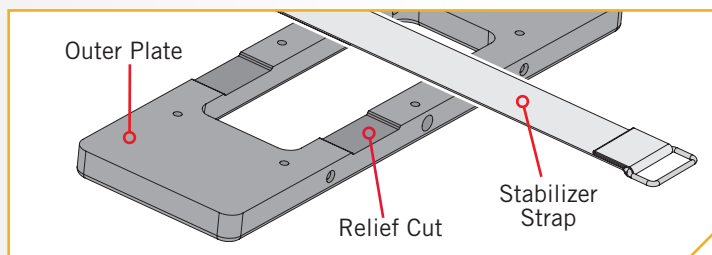
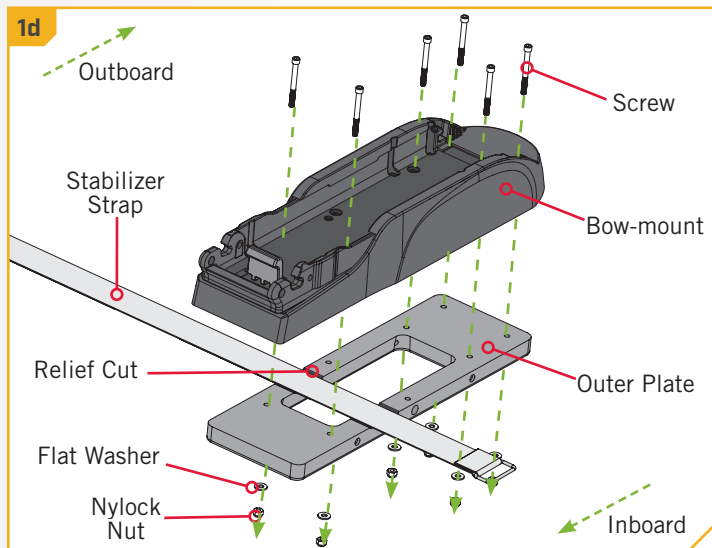

⚠ CAUTION

The Stabilizer Strap must be located in the Relief Cut or failure of the Quick Release Bracket may occur.

› Installing the Outer Plate to a Fortrex, RT Fortrex or Ultrex

1

WARNING

For installation, do not remove the shaft/motor from the Bowguard. The Bowguard spring is under tension and must always remain secured.

NOTICE: For Ultrex motors, please review the “Disconnect the Gas Spring” section of the Ultrex Owner’s Manual (#2297160) online at minnkotamotors.com.

NOTICE: For Fortrex motors, please review the “Disconnect the Gas Spring Pin” section of the Fortrex Owner’s Manual (#2287100) online at minnkotamotors.com.

1a

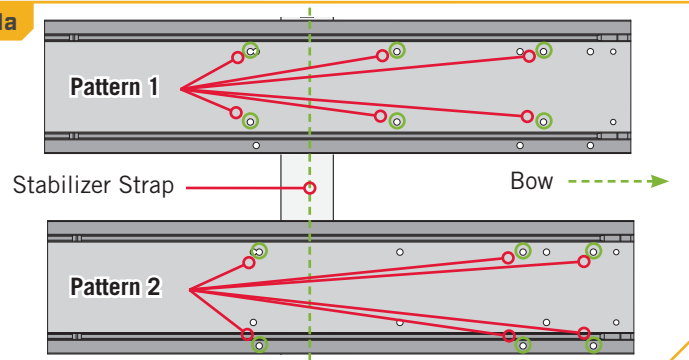

NOTICE: If Pattern 2 is used, the right Side Plate must be removed to access the mounting holes in the base of the Mount. Use a #2 Screwdriver to remove the Side Plate.

- Determine which bolt pattern to use. The bolt pattern selected will depend on the deck space available on your boat.
- It is recommended to mark at least four of the six holes in the Base Extrusion and to have two bolts on each side of the Stabilizer Strap that are located the farthest apart on the Mount Plate. Ideal installation would allow for six bolts to be used, with a minimum of four.

2

ITEM(S) NEEDED



#4 x 1

- Place the Stabilizer Strap (if included with your motor) into the Relief Cut on the Outer Plate (Item #4). Be sure the Stabilizer Strap sits under the Base Extrusion between the second and third set of bolts according to the mounting pattern selected. The placement of the buckle on the Stabilizer Strap is based on personal preference and can be placed either inboard or outboard. Orientate the buckle to the desired side. The hook and loop on the fastener should be face down for the Stabilizer Strap to function.
- Test the placement of the Stabilizer Strap to be sure it can hold the Mount as placed. Double check that the strap can close around the Mount when the motor is stowed.

CAUTION

The Stabilizer Strap must be located in the Relief Cut or failure of the Quick Release Bracket may occur.

2c

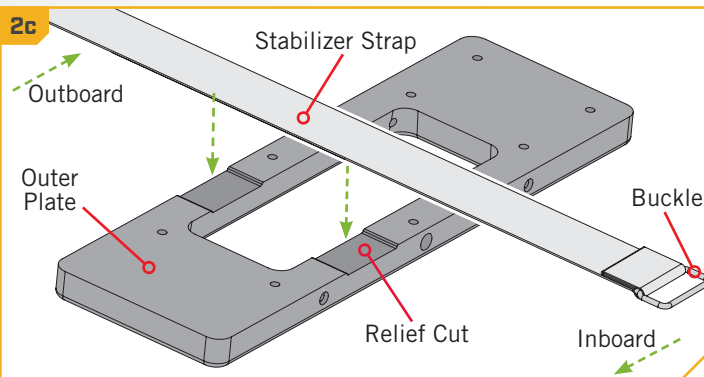

3

ITEM(S) NEEDED



- e. Align the Base Extrusion with the mounting holes of the Outer Plate.
- f. Use six 1/4" x 1 1/8" Socket Head Screws (Item #22), six Flat Washers (Item #18) and six Nylock Nuts (Item #24) to fasten the motor mount to the Outer Plate. The Screws should pass through the Base Extrusion, then the Outer Plate, then the Flat Washers and be secured by a Nylock Nut.
- g. If it was removed, reinstall the right Side Plate with the Screws and a #2 Screwdriver.

NOTICE: To prevent seizing of the stainless steel hardware, do not use high speed installation tools. Wetting the screws or applying an anti-seize may help prevent seizing. If possible, secure all sets of mounting bolts, nuts and washers.

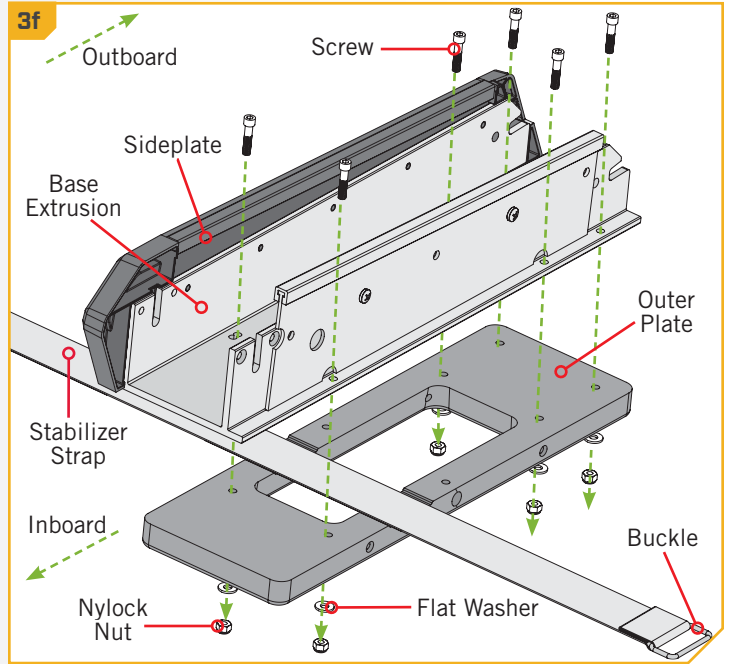

Installing the Inner Plate to the Bow

1

ITEM(S) NEEDED



- a. Determine if the motor will be mounted on the Port or Starboard side of the bow and if the Handle Assembly (Item #6) will release inboard or outboard. Be sure that the Handle Assembly will not encounter any obstructions on the bow of the boat and can be completely pulled out to release the plates when mounted. The bracket is designed so that the handle can be positioned on either side to accommodate clearances and personal preference. The side of the bracket that the Handle Assembly is used on will determine which side the Padlock Pin (Item #8) will be installed on.

NOTICE: Make sure that the motor will not encounter any obstructions when positioning the motor on and off the Quick Release Bracket. The exact placement of the motor and bracket, when mounting, may vary depending on the boat, boat deck, and which base extrusion the bracket is being mounted to.

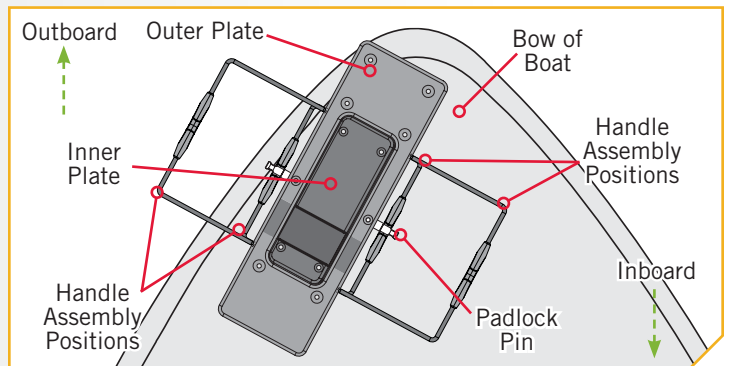
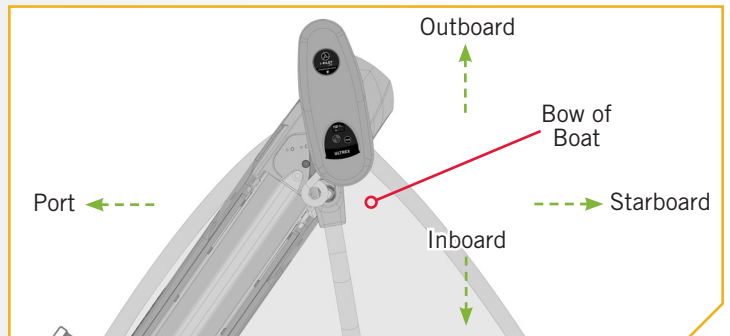

2

- b. Place the Quick Release Bracket with the motor attached as close to the center line or keel of the boat as possible. Make sure to check the clearance of the motor, bracket and handle assembly for any possible obstructions on the bow of the boat.

NOTICE: It is recommended to have a second person help with this step of the installation.

- c. Check placement with the motor in the stowed and deployed positions. Review the mounting considerations at the beginning of the installation. When the motor is in the deployed position, make sure that the Shaft is 1-1/2" out past the Gunwale of the boat. The lower unit, when stowed and deployed, must not encounter any obstructions.
- d. Mark the side edges and rear of the Outer Plate on the bow of the boat. These markings will be used to position a template that will be used to mark and drill the holes for the Inner Plate.

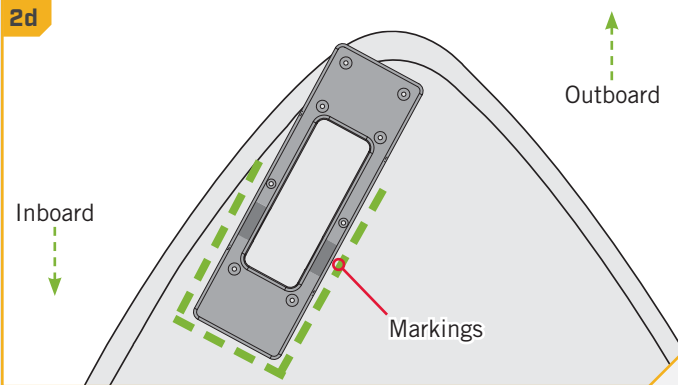
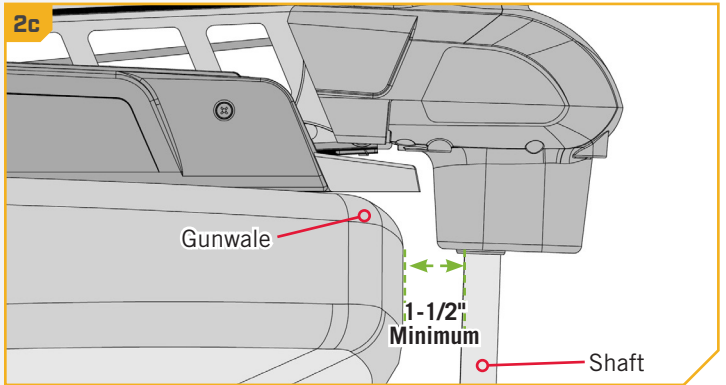
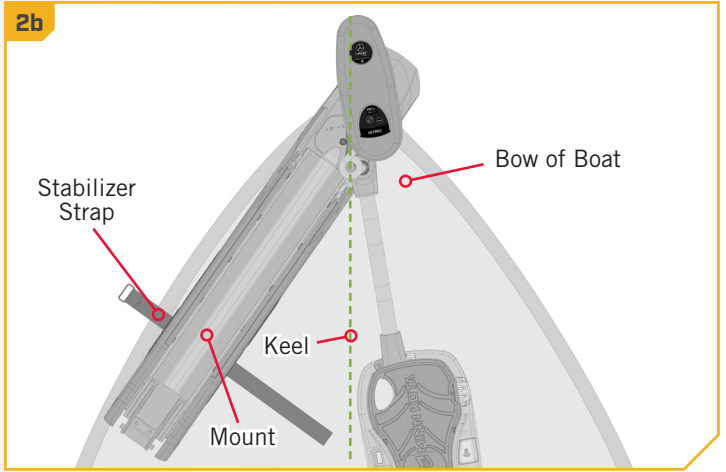

3

ITEM(S) NEEDED



#8 x 1



#12 x 1

- e. Once an orientation for the Handle Assembly is selected, place the Padlock Pin (Item #8) into the Outer Plate on that side, oriented so that the larger diameter of the Pin is in the Outer Plate. Rotate the Pin so that the hole in the Pin lines up with the hole in the Outer Plate. Secure the Pin with the 1/4-20 X 7/8 Screw (Item #12) using an #3 Screwdriver.

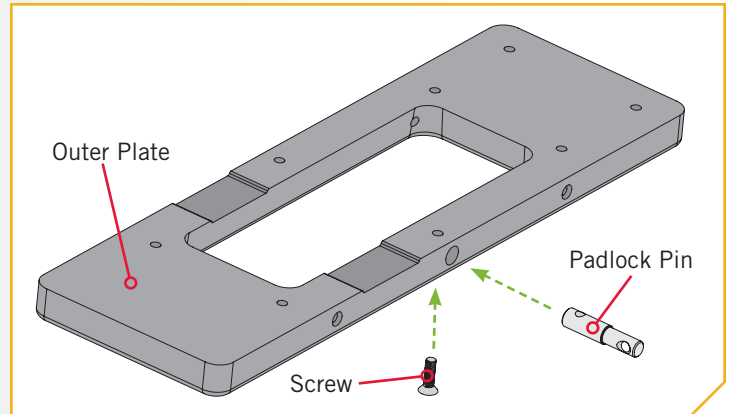
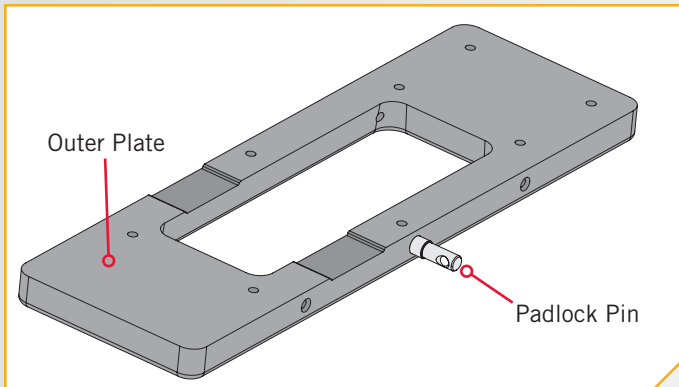

4

- f. Take the box that the Quick Release Bracket came in and carefully pull the glued edges apart and open the box so that it lays flat. On the inside of the box a template is printed to help locate, mark, and drill the holes for the Inner Plate. Cut the template out and place it on the bow. Align it with the markings that were made while checking handle and motor clearances. Make sure that the orientation of the Outer Plate in the template matches the orientation of the Outer Plate as it is attached to the Motor.
- g. The template indicates four drill holes on the Inner Plate. Use the template to mark the locations of the drill holes. When marked, lift the template away.
- h. Use a 17/64" drill bit to drill the holes.

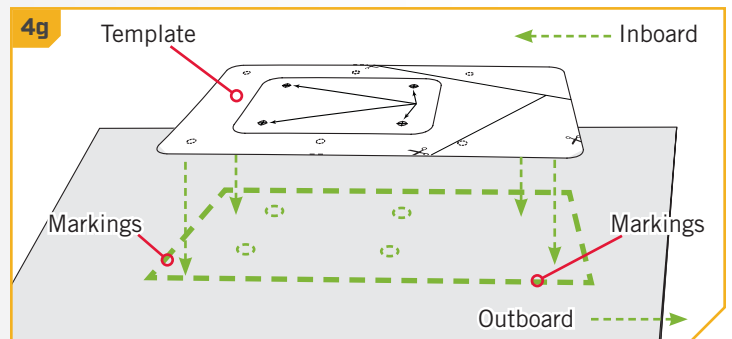
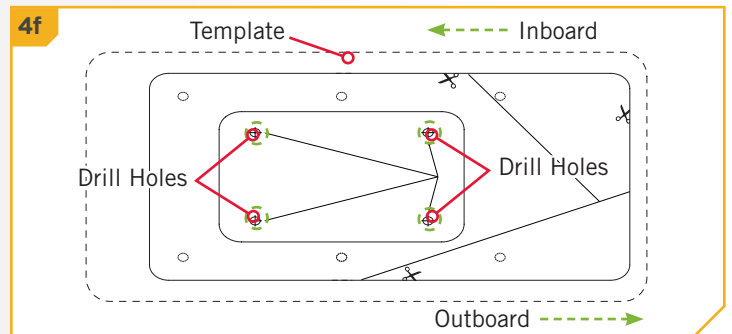

ITEM(S) NEEDED



#2 x 1



#14 x 4



#16 x 4



#24 x 4

- i. Place the Inner Plate (Item #2) on the bow of the boat and align it with the holes that were drilled using the template as a guide. For the best fit, it is recommended that the mounting surface under the Inner Plate is completely flat. If needed, use shims or rubber washers to level the mounting surface. If the Inner Plate is not mounted flat, the Handle Assembly will not slide properly.

NOTICE: Make sure the orientation of the Relief Cut on the Inner Plate matches the orientation inboard of the Outer Plate.

- j. Put a 1/4-20 X 2" Flat Head Screw (Item #14) in each of the six drilled locations. The bolt should pass through the Bottom Plate then the boat deck.
- k. Place a Flat Washer (Item #16) and a Nylock Nut (Item #24) at the end of each bolt and tighten with a 7/16" Box End Wrench. Make sure all hardware is secure.

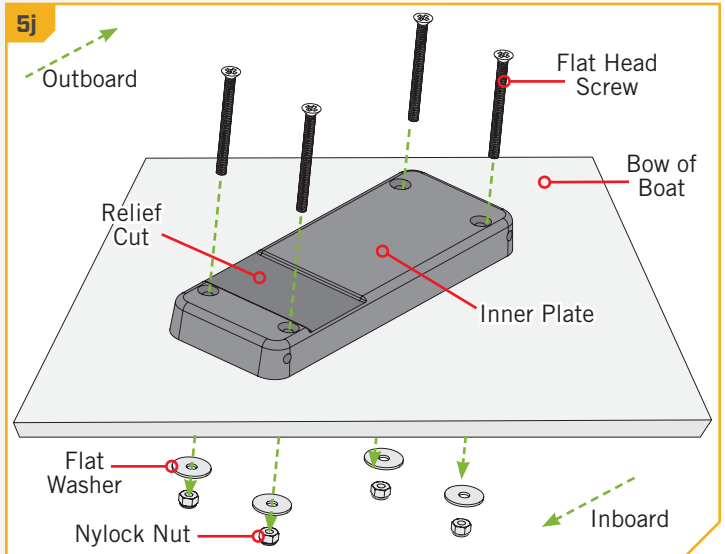

CAUTION

The Stabilizer Strap must be located in the Relief Cut or failure of the Quick Release Bracket may occur.

› Completing the Installation

1

ITEM(S) NEEDED



#10 x 1

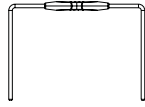

#6 x 1

- Position the opening in the Outer Plate over the Inner Plate. Mount the motor onto the Inner Plate.
- Slide the Handle Assembly (Item #6) into the rod holes of the Outer Plate. Slide the Hair Clip Pin (Item #10) through the Lock Pin to secure the Handle Assembly.
- Your motor is now ready to be mounted. Always make sure the Handle Assembly is fully inserted and retained by the Hair Clip Pin.

NOTICE: A padlock can be used in place of the Hair Clip Pin to prevent motor theft.

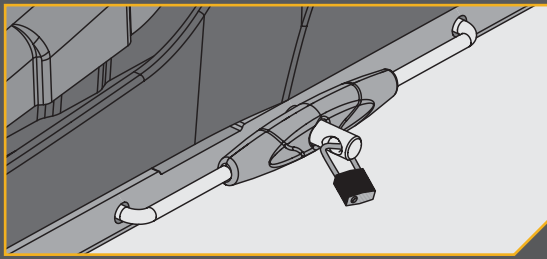

NOTICE: If the Handle Assembly does not slide easily into place after completing the installation, it may be necessary to drill out the Handle Rod Holes using a letter "F" (.257") drill bit.

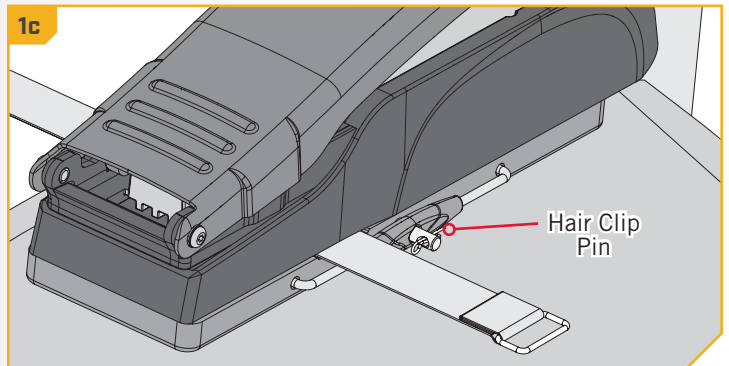
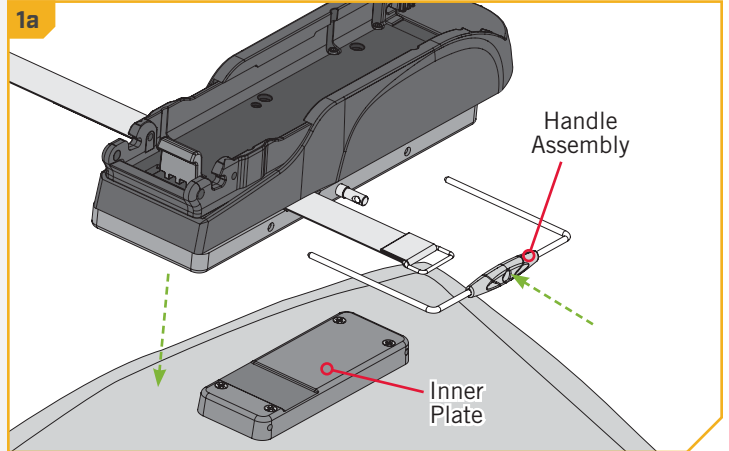

NOTICE: To reinstall the lift cylinder for Ultrex motors, please review the "Installing the Gas Spring Pin" section of the Ultrex Owner's Manual (#2297160) online at minnkotamotors.com.

NOTICE: To reinstall the lift cylinder for Fortrex motors, please review the "Installing the Gas Spring Pin" section of the Fortrex Owner's Manual (#2287100) online at minnkotamotors.com.

For warranty information, please visit minnkotamotors.com.



Minn Kota Consumer & Technical Service
Johnson Outdoors Marine Electronics, Inc.
PO Box 8129
Mankato, MN 56001

121 Power Drive
Mankato, MN 56001
Phone (800) 227-6433
Fax (800) 527-4464



©2020 Johnson Outdoors Marine Electronics, Inc.
All rights reserved.