

Installation Instructions



Single Level Waste Tank Alarm (TM-132)

Operation

The panel provides indication that the contents of the waste tank are at or above 3/4 full. This measurement is activated by gently placing your finger over the blue LED labelled 'Touch to Monitor'. If the red LED (3/4) is illuminated during monitoring, the tank is at or above 3/4

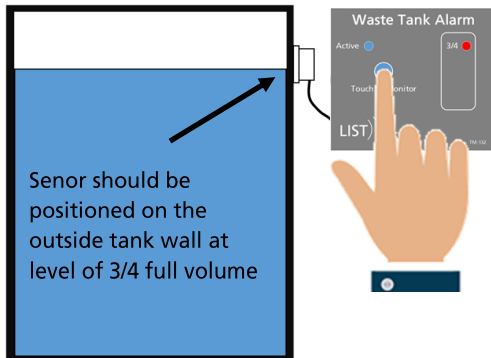

Package Contents

- 1 x 'Touch to Monitor' panel and enclosure with 3M adhesive bezel mount
- 1 x 3M Surface Preparation Wipe
- 1 x CLS Sensor with 3M adhesive pad, cable and Connector
- 2 x Crimp Connectors for power supply
- 1 x Panel cut-out template

Before Installation

- Identify an appropriate location for the panel. This should be close to the tank in a dry location. Please take care to ensure correct clearance behind the surface on which panel will be installed.
- Ensure there is a clear path between the tank and panel in order to route the cable and connector from the tank to the rear of the panel
- Choose a side of the tank to which the sensor is to be attached. This should be accessible, clean, dry and at least 1" (25mm) from the corner of the tank.

Installation

- Step 1/** Using the template provided, carefully cut the opening for the panel. Do not remove the backing from the adhesive pad on the bezel
- Step 2/** Place the tank sensor in the general area of the tank and route the connector through the boat to meet the connector on the rear of the panel. The connectors can be joined and the nut hand tightened.
- Step 3/** Connect the power to the rear of the panel using appropriate power source through an appropriate fuse or circuit breaker. Crimp connectors have been provided.
- Step 4/** Once connected, you can turn on the power. The panel will display a single blue light. Gently touch the area of the panel to check panel is activating the sensor. The blue LED (Active) should illuminate. If the sensor is connected you will see a quick flash of the red LED upon activation. This will last for less than a second.
- Step 5/** If you have a helper, the sensor function can be checked by gently placing your thumb on the 3M pad on the sensor while the 'Touch to Monitor' is activated on the panel. Placing and removing your thumb will activate the red LED. If you know the general area of the liquid level, you can gently slide the sensor over the full section of the tank to ensure a reading though the tank wall. The LED light on the sensor will light when liquid has been detected. This will correspond to the red LED on the panel.
- Step 6/** When functionality has been checked, you can prepare to adhere the panel and the sensor to their surfaces.
- Step 7/** Remove the 3M Cleaner from the packet and wipe the tank surface in the area the sensor is to be placed. The sensor should be place 3/4 of the way up the side of the tank. As some tank shapes are irregular, the sensor may need to be offset to allow for 3/4 volume
- Step 8/** Using the same cleaner, wipe the surface around the area where the panel, will be placed.
- Step 9/** Remove the 3M backing from the sensor pad and press the sensor firmly onto the outside tank wall. Hold in place for around 5 seconds.
- Step 10/** Remove the backing from the panel bezel adhesive pad and press the panel firmly into position. Hold for 5 seconds.

For assistance, please call our toll free USA helpline (800-576-0530) or email list@nixonmarineglobal.com

LIST Products are manufactured in N. Ireland, UK by Nixon Marine Global Ltd

www.nixonmarineglobal.com