

# T-TOP Installation Guide

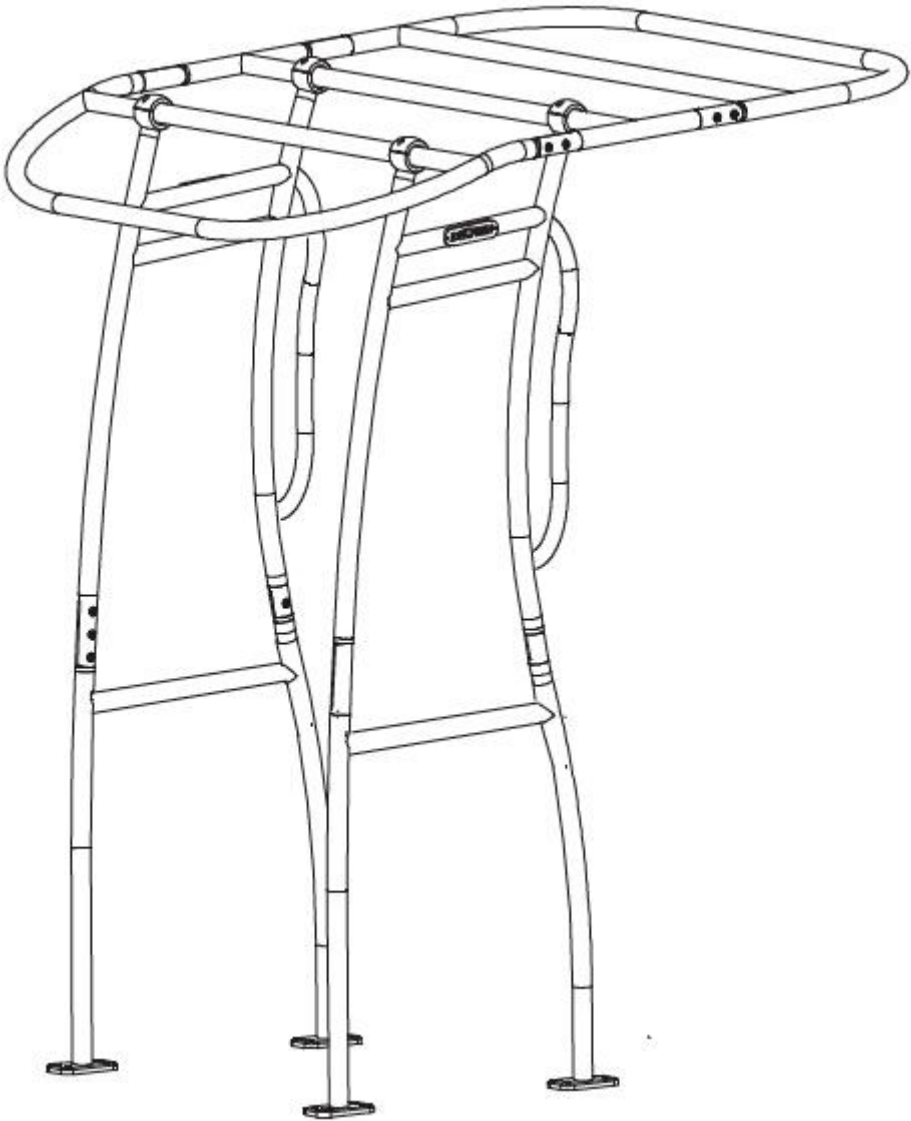

EXPLODED VIEW OF THE DOLPHIN PRO T TOP FOR REFERENCE

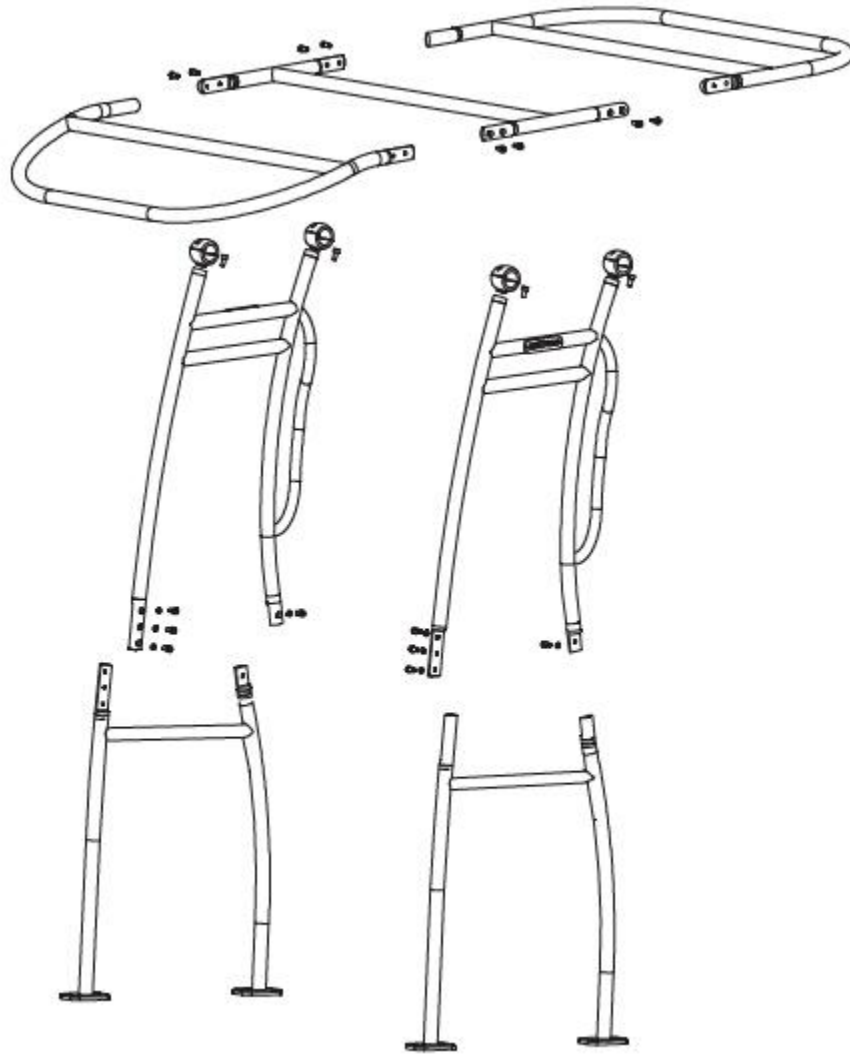

**STEP 1:**

Unpack and check the contents of the box and check parts list.

Please Read all Instructions prior to installation

If you are NOT sure of any part of the guide or you have any questions

Please contact the supplier or DOLPHIN T Tops

**PARTS LIST**

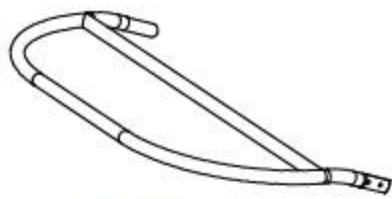

1 x Front

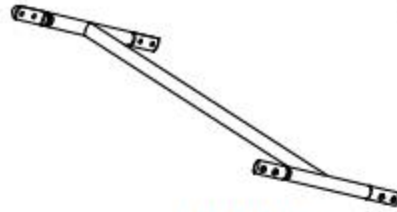

1 x Centre



1 x Rear

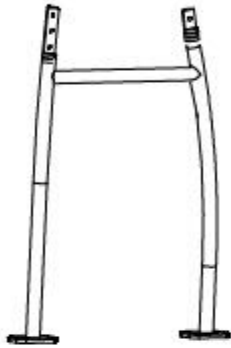

1 x base Stbd

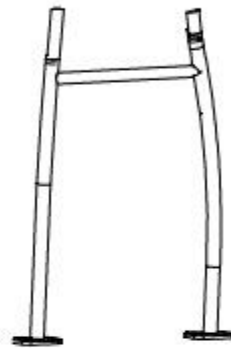

1 x base Port

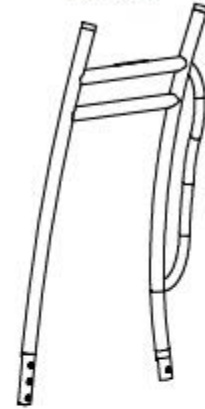

1 x Stbd

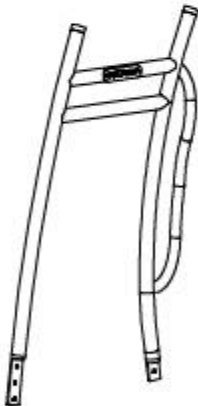

1 x Port

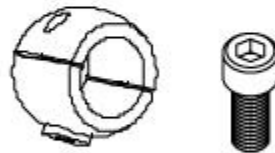

4 x Ball Clamps with  
4 x Rubber inserts  
4 x Allen head bolts



8 x M12 Bolts for Main  
Support frame



8 x M10 Bolts  
for top section frame

1 X CANVAS  
TOP COVER WITH ZIPPER

2 x Standoffs with bolts  
16 x long bolts and nuts  
& backing plates for deck  
mounts

STEP 2:  
Positioning of the lower half of the side frame.

Distance from the center console to lower side frame (1inch to 7inch) Check under the floor for

wires or other objects that could affect the mounting Place the lower half of side frame in the desired position and mark as a reference Remove the side frames and Measure the distance between the front mounting position from Port to Starboard (side to side) Right this measurement down

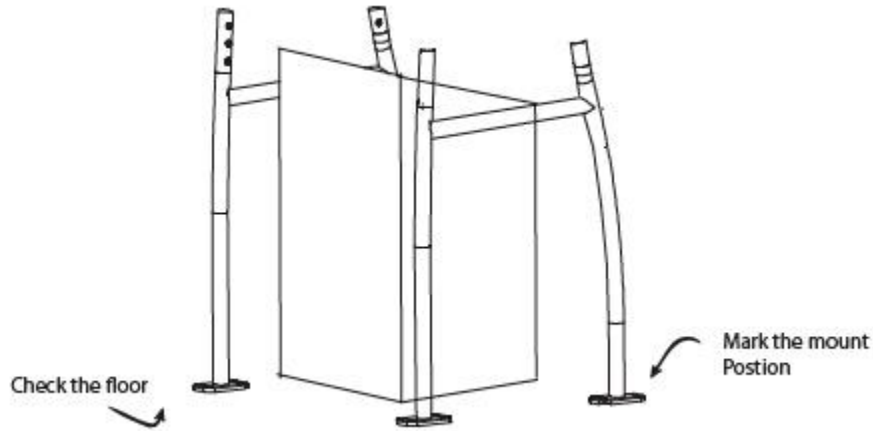

### STEP 3: Assemble the side support frame

Attach the lower half and upper half of the side frames using the bolts and split washers. Note the Dolphin logo faces outwards from the boat Note the bolt heads will be concealed in the counter sunk area and face inwards towards the console. Note you have a Port and Starboard Side Frame as described above logos facing outwards

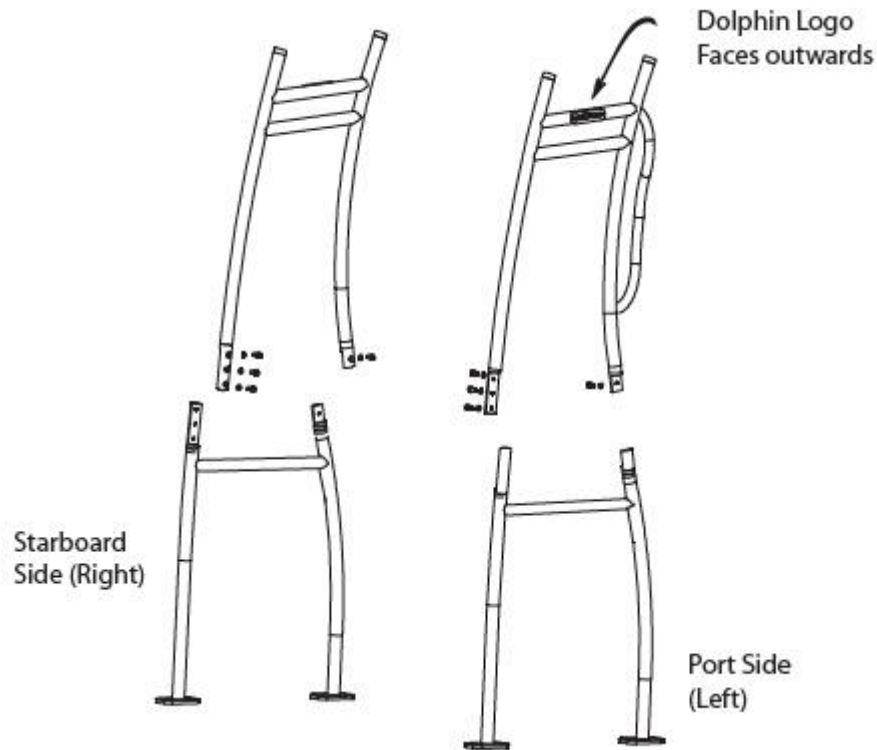

#### STEP 4: Attach the ball clamps to top of Side Frames

The top of the side frame has a counter sunk circle with a threaded hole, the ball clamps have a raised circle area. Insert the raised circle area into the counter sunk hole of the side frame insert bolt from inside the ball clamp into the side frame end and tighten. NOTE Allow the ball clamp to rotate very slightly for adjustment.

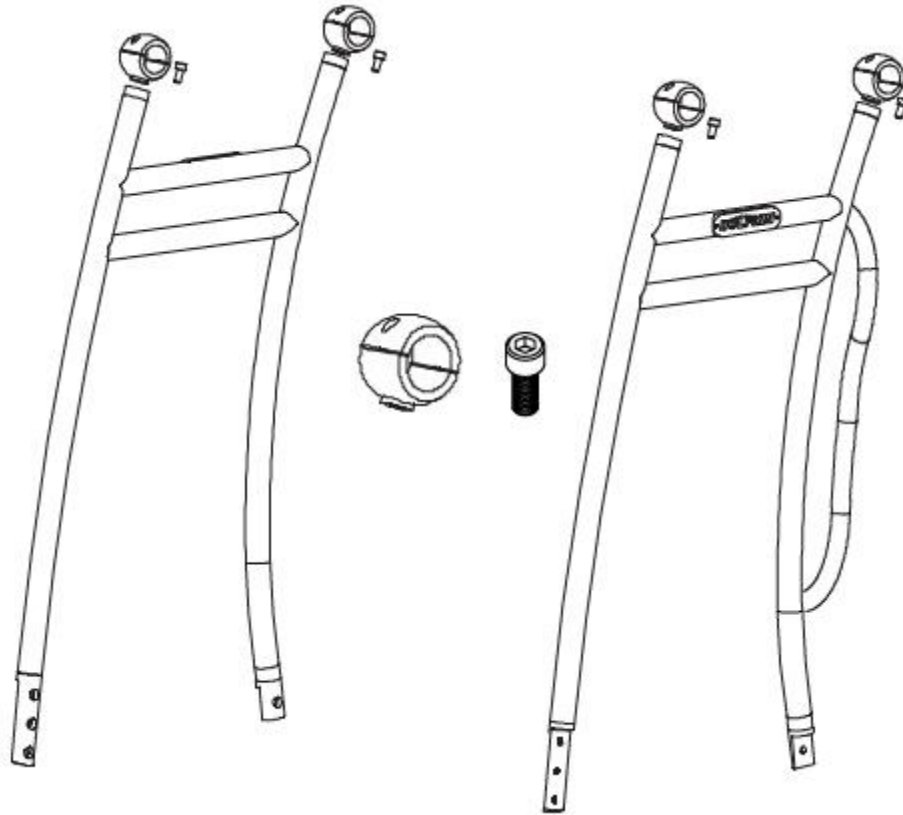

STEP 5: Assemble the front and center section of the top frame

Note the shape of the front section is narrow and also has a bend curve which faces downwards when attached to the side support frames of the T Top.

Note the lap joints have a number on the flat face match these up for correct installation

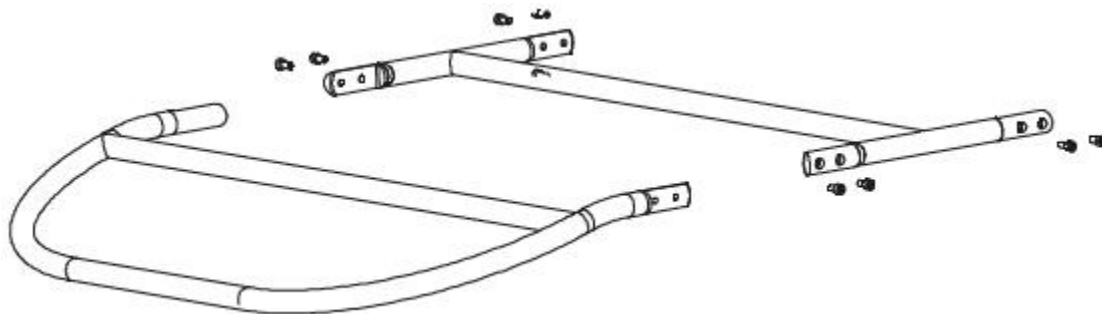

STEP 6: Attach the Side Supports to the Assemble Top Section

Check the direction of the side support arms Logo to the outside, handle to the rear The small curved top frame for the cover curves and bends downwards to the floor

Remove the tops of the ball clamps please NOTE the clamps are to be placed on the same way (they are numbered inside)

Find the center of the cross bar on the top section mark this. Use the measurement you marked out for the position of the deck mounts Mark this in the two cross beams on the top section that is assembled.

Attach the partial top section to the support frame ensuring all parts are facing the correct direction. (Refer to pictures of T Tops for reference if unsure.)

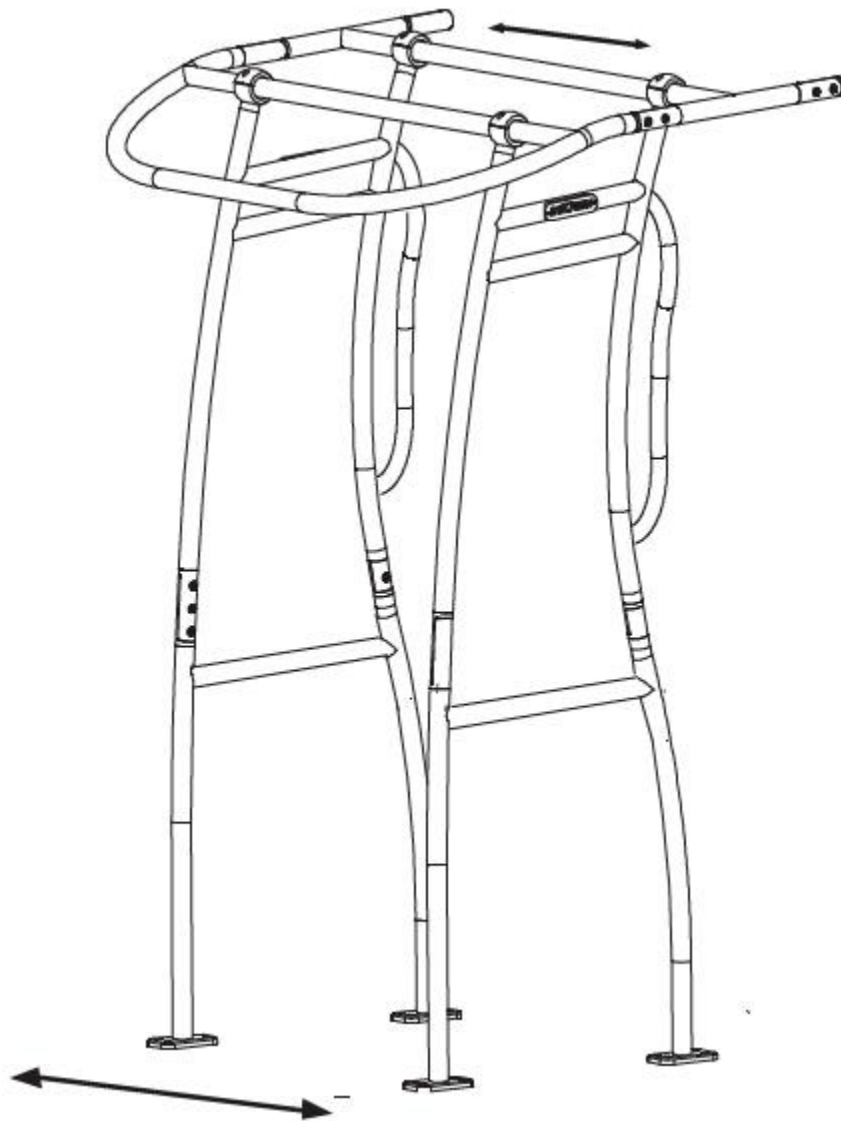

STEP 7: Attach the T top to the floor of the boat

Place the T Top you have assemble on the marks you have made near your console Now you can pre drill and use the bolts and backing plates and lock in you mounting points NOTE: Check under the floor for any wires or objects before drilling holes.

STEP 8: Attach rear section of the top frame to the T Top

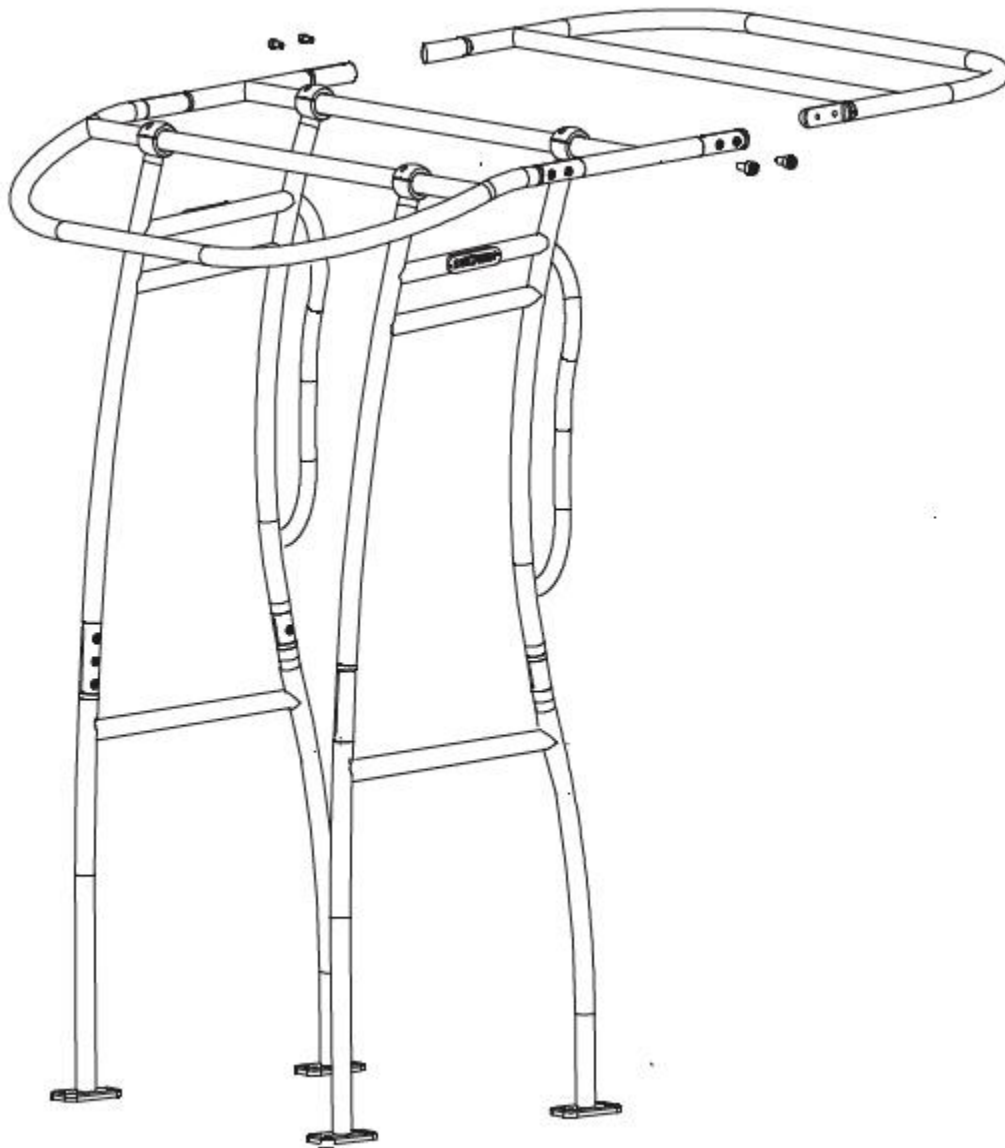

STEP 9: Attaching the Sunbrella Material cover to the top frame.

Remove the cover and lay out on the ground. Note: there is a zipped front pocket which is

zippered from side to side. Place this over the front section of the T top and zipper up now you can fold out over the rest of the top frame and hook over the back and zipper this section up and the Velcro corner sections. Now you can pull tight the side section with zippers and Velcro tabs.

STEP 10: Attaching standoffs to T Top side main frames.

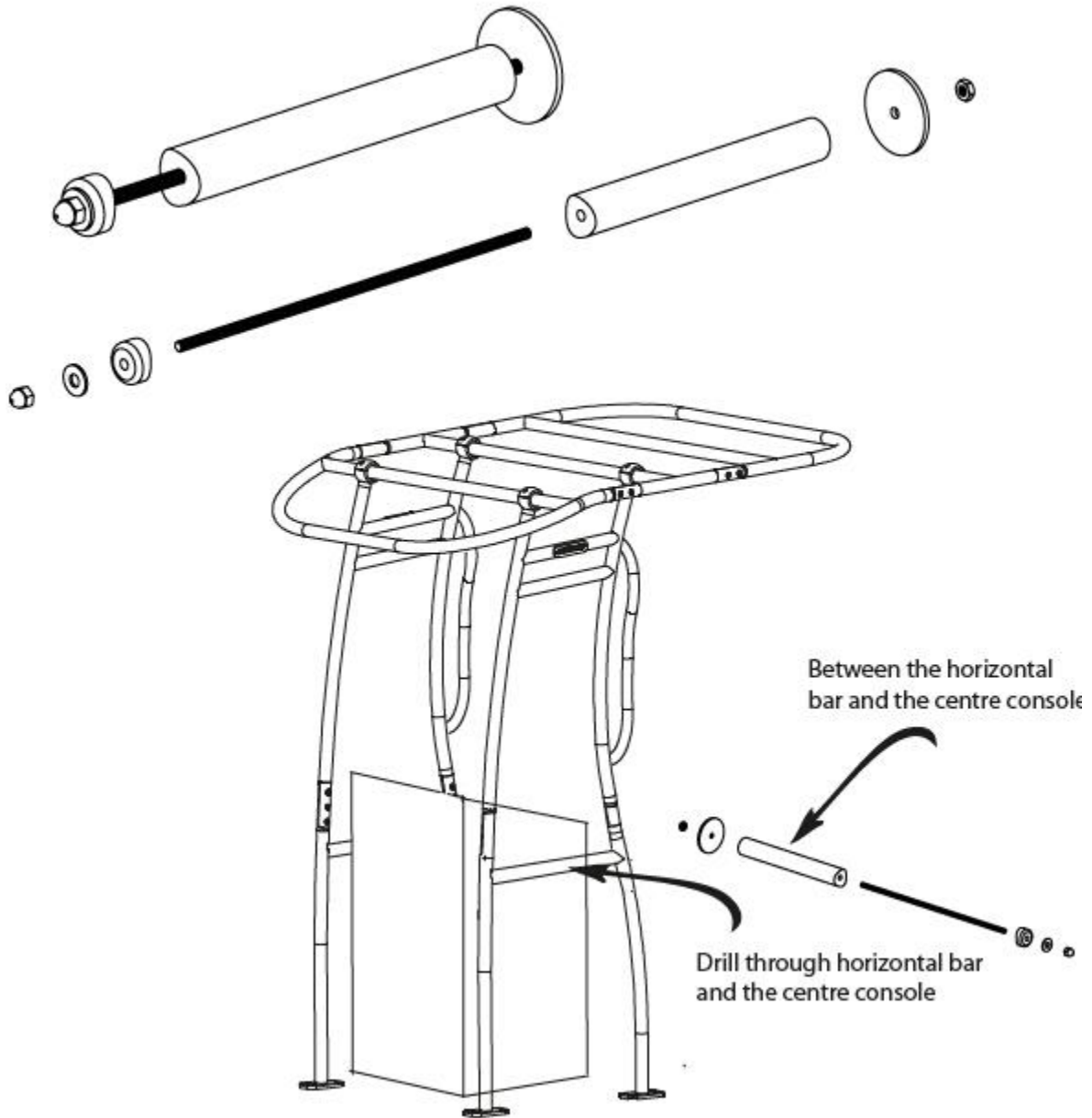

#### CARE AND MAINTENANCE

Be sure to check and tighten all fasteners and connections prior to every use. Be cautious when towing or driving under obstacles, low hanging structures or trees. Leave dolphin top in the

erect position when towing behind a vehicle Use soap and water to clean your tower. Avoid abrasive material that might scratch or damage the tower protective Finish. Always rinse and wipe down tower after contact with salt (brackish) water.

#### WARNING

The construction of your boat, design, thickness of flooring deck and walls and overall design may cause movement at the mounting points. If the construction of you boat causes movement at the mounting points or incorrect mounting location creates added pressure on joints increasing movement of the t top it voids warranty. If in doubt do not install the t top Check all bolts and parts prior to use, especially after towing behind a vehicle, lowering and raising after storage.

#### WARNING

Do not stand, climb or jump o# tower, do not tow the boat behind a vehicle with the t top lowered. Do Not Ski, wake, tow tubes, boats or another watercraft from the tower. Watch out whilst moving under objects, such as bridges, low building and trees.